

# CONFORTO FURNACE SPECIFICATION GUIDE

## KEY FEATURES:

- Energy Star Rated at **ALL** Firing Rates
- Oil AFUE Ratings Ranging from 86% - 96.7%
- Non-refractory Combustion Chamber
- Warranty: 10 Year on parts. Limited Lifetime on Heat Exchanger



KLC



KLR



KLF



KHM

## FIRING RATE SPECIFICATIONS

Model	Style	Oil Ratings			Gas Ratings			Burner Options			Order No.	ECM		PSC			
		Inputs		Outputs	AFUE	Input	Output	AFUE	Chimney			DV	1/2 HP	3/4 HP	1/2 HP	3/4 HP	
		G.P.H	MBH	MBH	%	MBH	MBH	%	Oil	Gas		Oil	1230 cfm	1910 cfm	1275 cfm	2030 cfm	
KLC 100	Lowboy	0.55-0.65	77-91	74-87	96.7	N/A	N/A	N/A	F3*	-	-	BF3*	KLC-00-G100-H3	X			
KLR 100	Lowboy	0.55-0.65-0.75	77-91-105	66-79-91	86.2 to 87.1	105	87	83.5	F3	AFG-L2	G120	BF3	KLR-00-G100-03			X	
KLR 200		0.85-1.00-1.15	119-147-161	102-126-139	86.5 to 87.8	155	131	83.5	F5	AFG-F	G200	BF5	KLR-00-G200-05				X
														KLR-00-G200-H5		X	
KLF 100	Lowboy	0.55-0.65-0.75	77-91-105	66-79-91	86.2 to 87.1	105	87	83.5	F3	AFG-L2	G120	BF3	KLF-00-G100-03			X	
KLF 200		0.75-0.85-1.00-1.10	105-119-140-154	93-102-119-132	86.3 to 88.6	155	131	83.5	F5	AFG-F	G200	BF5	KLF-00-G200-05	X			X
														KLF-00-G200-H5		X	
KHM 100	Hiboy Multi Position	0.55-0.65-0.75	77-91-105	66-79-91	86.0 to 86.9	105	87	83.5	F3	AFG-L2	G120	BF3	KHM-00-G100-03			X	
KHM 200		0.85-1.00-1.15	119-147-161	102-126-139	86.4 to 87.5	155	131	83.5	F5	AFG-F	G200	BF5	KHM-00-G200-05	X			X
														KHM-00-G200-H5		X	

\* The KLC - Condensing Oil Fired Furnace CANNOT be vented directly into a chimney or standard Direct Vent System. Chimney may be used as a chase for appropriate plastic venting material OR an approved side wall plastic venting material may be used. Please reference the KLC installation manual for details.

## DIMENSIONAL SPECIFICATIONS

Model	Cabinet Dimensions			Supply Plenum	Return Plenum	Plenum Spacing	Filter		Flue	Weight
	Height	Width	Depth				Size	Qty		
	in	in	in	in	in	in	in	#	in	LBS
KLC 100	36 7/8	21 1/2	50 1/4	20 X 20	20 X 20	3	12 x 20 x 1	2	3 REAR	246
KLR 100	33	21 1/2	49 1/8	20 X 20	20 X 20	2 1/8	20 x 20 x 2	1	5 REAR	204
KLR 200	33	21 1/2	55 1/8	20 X 24	20 X 22	2 1/8	20 x 20 x 2 15 x 20 x 2	1 1	5 REAR	240
KLF 100	29 3/8	21 1/2	53 5/8	18 X 21 3/4	18 X 20 3/4	2	20 x 20 x 2	1	5 FRONT	210
KLF 200	35 1/8	21 1/2	52 5/8	20 x 24	20 x 20	2	15 x 20 x 2	2	5 FRONT	240
KHM 100	46 1/4	21 7/16	26	20 X 20	18 X 18	N/A	20 x 20 x 2	1	5 FRONT	204
KHM 200	49 7/8	21 7/16	30	24 X 20	23 X 18	N/A	20 x 25 x 2	1	5 FRONT	240





# CONFORTO

## FURNACE BURNER / DIRECT VENT SPECIFICATION GUIDE

### BURNER PART NUMBERS

Fuel	Order Number	Model	Vent Type	KHM		KLR		KLF		KLC
				100	200	100	200	100	200	100*
Oil	<b>A00-BN-4050-60</b>	Beckett AFG-L2	Chimney	•		•		•		
	<b>A00-BN-F3N0-60</b>	Riello 40-F3	Chimney	•		•		•		•*
	<b>A00-BN-BF3N-60</b>	Riello 40-BF3 DV	Direct Vent	•		•		•		•*
	<b>A00-BN-EZLF-50</b>	Carlin EZ LF	Chimney	•		•		•		
	<b>A00-BN-4050-90</b>	Beckett AFG-F	Chimney		•		•		•	
	<b>A00-BN-F5N0-85</b>	Riello 40-F5	Chimney		•		•		•	
	<b>A00-BN-BF5N-85</b>	Riello 40-BF5 DV	Direct Vent		•		•		•	
	<b>A00-BN-EZLF-85</b>	Carlin EZ LF	Chimney		•		•		•	
Nat. Gas	<b>HQG120N</b>	Riello G120N	Chimney	•		•		•		
	<b>HQG200N</b>	Riello G200N	Chimney		•		•		•	
LP Gas	<b>HQG120P</b>	Riello G120P	Chimney	•		•		•		
	<b>HQG200P</b>	Riello G200P	Chimney		•		•		•	

### Steps for properly selecting a Conforto Direct Vent System

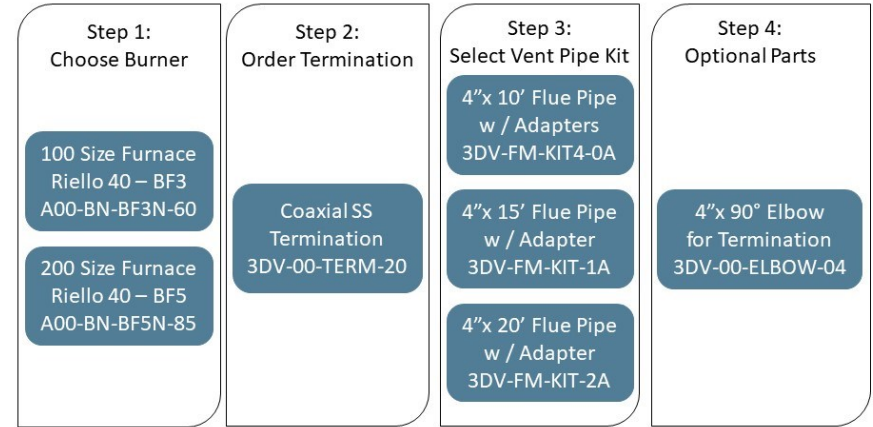

### NOZZLE CHART

Note: Nozzle shown in **BOLD** depicts the nozzle supplied in the burner box.

	KLR-100 / KLF-100 / KHM-100			KLR-200 / KLF-200 / KHM-200			KLC-100		
<b>Riello Burner</b>	<b>Riello - F3 (Chimney Vent)</b>			<b>Riello - F5 (Chimney Vent)</b>			<b>Riello - BF3 (2 Pipe Venting)</b>		
	<b>Riello - BF3 (Direct Vent)</b>			<b>Riello - BF5 (Direct Vent)</b>			<b>Riello - F3 (1 Pipe Venting)</b>		
	Input	77,000	91,000	105,000	126,000	147,000	161,000	77,000	91,000
	Output	67,000	79,000	91,000	109,000	126,000	139,000	74,000	87,000
Nozzle Size	.40 x 70A	<b>.60 x 70W</b>	.65 x 70W	.75 x 80W	<b>.85 x 70W</b>	1.00 x 70W	.50 x 70W	<b>.60 x 70W</b>	
<b>Beckett Burner</b>	<b>AFG L2 3-3/8 (Chimney Vent)</b>			<b>AFG F3 2-3/4 (Chimney Vent)</b>					
	Input	77,000	91,000	105,000	119,000	140,000	154,000		
	Output	66,000	78,000	90,000	102,000	119,000	132,000		
	Nozzle Size	.50 x 60W	<b>.60 x 60W</b>	.65 x 60W	.75 x 70B	<b>.85 x 70B</b>	1.00 x 70B		
<b>Carlin Burner</b>	<b>EZ LF (Chimney Vent)</b>			<b>EZ LF (Chimney Vent)</b>					
	Input	74,000	89,000	103,000	116,000	138,000	150,000		
	Output	64,000	76,000	87,000	100,000	115,000	125,000		
	Nozzle Size	.50 x 70A	<b>.50 x 60B</b>	.65 x 60B	.65 x 70w	<b>.85 x 70B</b>	.85 x 70B		

